

# MOUNTING TRACK

Project:

Type:

Catalog Number: **WUC, BUC, CUC, LST, PLSWTRK, PLSCTRK**

System Component: **TRACK**

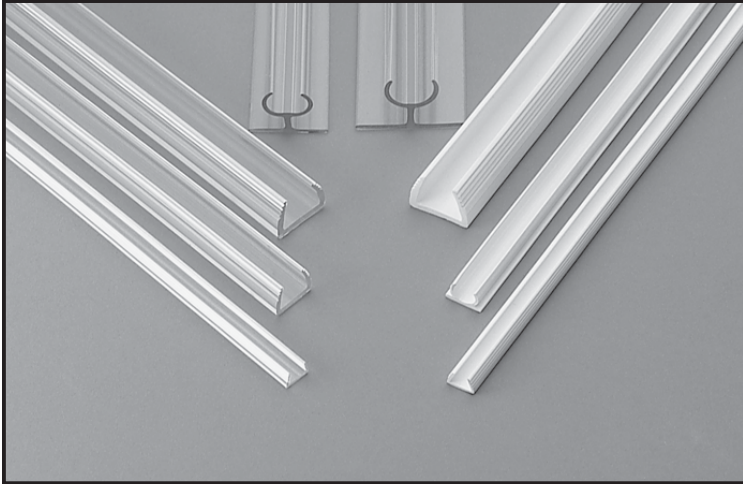

- ◆ 7 foot (2.1 meters) lengths can be "field" cut to length
- ◆ Vandal resistant
- ◆ UV stabilized
- ◆ Reflective properties of WUC increase brightness
- ◆ Optical fiber is visible from one side with BUC, WUC and PLSWTRK
- ◆ Optical fiber is visible from three sides with CUC and PLSCTRK
- ◆ Optical fiber is visible from all sides with LST

**DESCRIPTION:** Lumenyte track provides a convenient method of mounting straight runs of linear optical fibers and cables to flat surfaces. Continuous end-to-end tracking is recommended for straight-line designs. WUC can be used to improve the reflected light output for SWN, SFC and LSL optical fibers. PLSWTRK and PLSCTRK for SFC201 or SFC301 only, is more flexible than WUC, BUC, CUC or LST tracks. Basic track installation information can be found in the "Mounting" section of the *General Installation and Design Guidelines* located under *Systems and Applications*.

# MOUNTING TRACK

## Ordering Information (All Dimensions are Nominal)

| Model            | A               | B              | Mounts Directly                 | Mounts With Weld-16 <sup>1</sup> | Mounts With LIC-RTV <sup>2</sup> |
|------------------|-----------------|----------------|---------------------------------|----------------------------------|----------------------------------|
| CUC/WUC204-7     | .33" / 8.5mm    | .22" / 5.6mm   | SWN200                          |                                  |                                  |
| CUC/WUC304-7     | .42" / 10.7mm   | .27" / 6.9mm   | SWN300/SFC201/<br>LSL-49        |                                  |                                  |
| CUC/WUC304-CC-7  | .48" / 12.2mm   | .31" / 7.9mm   | SFC301                          |                                  | SFC201-WR                        |
| BUC/CUC/WUC404-7 | .52" / 13.1mm   | .41" / 10.4mm  | SWN400/SFC302/<br>LSL-144/SB300 | LEF310M<br>LSL-84/SB255          | LEF310M-WR<br>SFC301-WR          |
| BUC/CUC/WUC504-7 | .70" / 17.8mm   | .53" / 13.5mm  | SWN500/SFC401/<br>LSL-144/SB300 |                                  | SFC401-WR                        |
| CUC/WUC504CC     | .72" / 18.3mm   | .56" / 14.2mm  |                                 | LEF410M                          | LEF410M-WR                       |
| CUC/WUC604-7     | .86" / 21.8mm   | .69" / 17.5mm  | SFC501                          |                                  |                                  |
| CUC/WUC610-7     | .92" / 23.4mm   | .71" / 18.0mm  |                                 | LEF510M/SFR510                   | SFC501-WR                        |
| CUC/WUC704-7     | 1.03" / 26.2mm  | .80" / 20.3mm  |                                 |                                  | LEF510M-WR<br>SFR510-WR          |
| CUC/WUC910-7     | 1.25" / 31.75mm | 1.02" / 25.9mm |                                 | LEF710M                          |                                  |
| LST406-7         | 1.17" / 29.7mm  | .84" / 21.3mm  | SWN500/SFC401/<br>LSL-144       |                                  |                                  |
| LST506-7         | 1.50" / 38.1mm  | 1.10" / 27.9mm | SFC501                          |                                  |                                  |
| PLSWTRK-201      | .56" / 14.2mm   | .31" / 7.9mm   | SFC201/LSL-49                   |                                  |                                  |
| PLSWTRK-301      | .59" / 15.0mm   | .37" / 9.4mm   | SFC301                          |                                  |                                  |
| PLSWTRK-401      | .83" / 14.2mm   | .50" / 7.9mm   | SFC401/LSL-144                  |                                  |                                  |
| PLSWTRK-501      | 1.0" / 15.0mm   | .60" / 9.4mm   | SFC501                          |                                  |                                  |
| PLSCTRK-201      | .56" / 14.2mm   | .31" / 7.9mm   | SFC201/LSL-49                   |                                  |                                  |
| PLSCTRK-301      | .59" / 15.0mm   | .37" / 9.4mm   | SFC301                          |                                  |                                  |
| PLSCTRK-401      | .83" / 14.2mm   | .50" / 7.9mm   | SFC401/LSL-144                  |                                  |                                  |
| PLSCTRK-501      | 1.0" / 15.0mm   | .60" / 9.4mm   | SFC501                          |                                  |                                  |

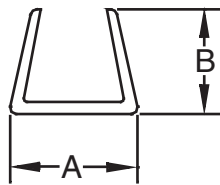

BUC/CUC/WUC 204-604, 610, 704,  
910 SEMI-RIGID

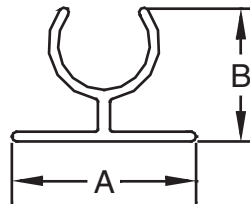

LST 406-506  
SEMI-RIGID

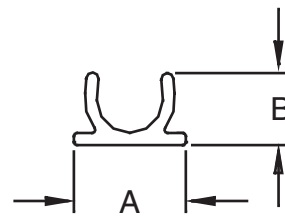

PLSCTRK 201-501  
PLSWTRK 201-501  
FLEXIBLE

**Color Key:**

|      |   |                             |
|------|---|-----------------------------|
| CUC  | = | Clear U-Channel             |
| WUC  | = | White U-Channel             |
| BUC  | = | Black U-Channel             |
| LST  | = | Clear Linear Standoff Track |
| PLSC | = | Clear Flanged U-Channel     |
| PLSW | = | White Flanged U-Channel     |

### Notes

1. Always use WELD-16 to bond unidirectional fibers (SB, LEF and SFR) in tracks or clips cut from these tracks.
2. Use LIC-RTV in track with -WR fibers. This helps to avoid air gaps in track in underwater applications.
3. Refer to Track Installation Guidelines located in the Systems and Applications Section of the Lumenyte Specification Binder for detailed installation information.

All LUMENYTE® Fiber Optics are Protected by either U.S. PATENTS or INTERNATIONAL or Specific Country PATENTS, or both.  
Copyright© 4 December, 2008. All Rights Reserved by LUMENYTE INTERNATIONAL CORPORATION.